



WiFi Smart Plug Instruction

Any problems please follow Gosund on  and consult the service staff

► Foreword

Welcome to Gosund. This user guide is intended to provide you important information about Gosund Mini Smart Plug. It is suggested that you read this user guide before installing the plug. If you have any questions, please feel free to contact us at service.eu@gosund.com or at our Official Facebook: <https://www.facebook.com/gosund.official/> Our customer service team will reply to you as soon as possible

► Precaution

1. Safety Information

- The device is only recommended for indoor use and in dry places and use the smart plug within its' published outlet rating on the instructions.

- Please plug the device in a socket fully and properly to ensure safety.

- Please keep the plug away from children.

- Please do not disassemble the device, otherwise it may cause

product damage and security risks.

1.Note

- On/Off button can be used as a factory reset button. Simply press and hold the on/off button to change the flashing speed.

If you want to change the network or location of the device, simply reset the product and it will delete the recent connection information.

- Please feel free to contact the seller for replacement if there is any damage caused from shipping.

▶ Product Package

Home Control Outlet
User Manual

▶ Product Structure

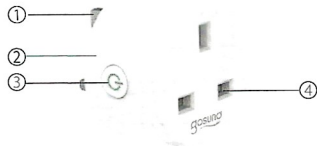

- ① Power Plug
- ② Flame Resistant Material
- ③ ON/OFF Button
- ④ Socket Panel

▶ Parameters

Rated VoltageAC	230V
Rated Current	13 A (Max)
AC Frequency	50/60Hz
Working Temp	-20~45°C
WIFI frequency	2.4Ghz
Maximum Total Power Output	2990W

▶ Install the “Gosund” APP

1. Search “Gosund” App on App store, Google Play or scan the QR code below and install it.

2. Please open the “Gosund” App. Click register and type in your email address to automatically create an account, otherwise type in your phone number to get a verification code to register an account. If you already have a “Gosund” account, simply click Login.

3. The free app “Gosund” is compatible with mobile devices that supports iOS 8.0 above and Android 4.4 above.



Gosund

▶ Connecting the device with “Gosund” APP

A. Easy Mode (Recommend)

1. Please open “Gosund” App. Tap

the “Add Devices” or the “+” sign at the upper right hand corner of the page and select “All Devices”, then select “Socket”.

2. Please make sure that the Gosund smart plug is connected or plugged at the same time. Then long press on/off button of the device for about 5 seconds until the indicator light rapidly blinks.

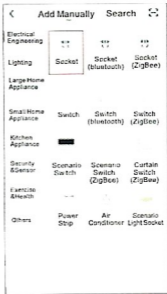

3. Make sure the indicator light is flashing rapidly and confirm it in the app.



4. Choose your Home WI-FI (make sure your phone is connected to 2.4GHz WI-FI channel not 5GHz) and enter the correct password. If the WI-FI channel is 5GHz and the password is incorrect, it will lead to "connection failure".



5. Finally, wait to successfully configure, then tap “Done”.

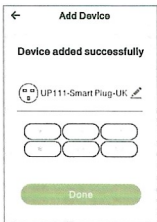

B. AP Mode

Please switch to “AP Mode” if the connection fails in “Easy Mode”.

1. The AP mode is located at the upper right hand corner of the “Add device” page.

2. Long press on/off button until the indicator light flashes slowly and confirm it in the App.



3. Choose your Home WI-FI and enter your correct password and confirm it in the App.

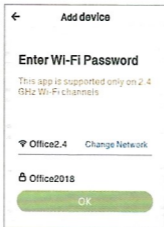

4. Tap "Connect Now", choose WI-FI hotspot named "Smart Life_XXX". If it shows, the current WLAN network

cannot access the Internet. Switch to another network?”, just tap “CANCEL” and go back to the “Gosund ” App.

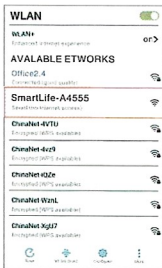

5. Finally, wait to successfully configure and tap “Done”.

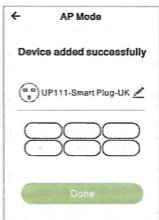

▶ Getting to Know “Gosund” App

A.Functions of Devices

You can add listed devices by tapping the “+” at the top right of the home page.

1.Switch : Remote control

Switch function allows you to turn on/off your device anywhere. You can control the device anywhere as long as you have an internet connection on your phone.

2.Timer

With the timer feature, you can automatically switch on/off the running household appliance you are using.

3.Schedule

You can set your appliance on and off at a specific time as you want using this function, which will be convenient at night time when sleeping, or when you arrive and leave office or your home.

4.Statistics

You can view real-time your device's energy consumption, which keeps energy bills low by effectively managing your most power consuming appliances.

B.Scenes

1.Touch the right top icon, and then you can create your characteristics to the device as you want.

2.You can change the name of the device, and choose to control the device by third-party devices such as Amazon Alexa, Google Home.

3.You can share the device to your family or create a group to help you control your devices at home.

4.Using the scenes, you can choose Remove the device or Restore Factory settings.

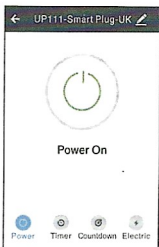

C.Profile

Profile will show the personal information you saved on the app. You can change and manage it anytime.

1. Personal Center: You can add your Profile Picture, re-name, set your account security, and choose temperature unit and time zone.

2. Home Management: You can set your Family name, manage your room and add your family members.

3. Help Center: You can send your feedback for a faulty device or any issues about the device.

4. More Service: It will show you how the device connects with the third party

devices.

5.Settings: You can check the firmware version of the device and update it when new version is available.

▶ Using Amazon Echo Quick Guide What You' ll Need...

Make sure your Echo dot is connected with your Amazon Alexa and you have a "Gosund" APP account.

A.Enable our Skill in Alexa APP

Log in your Amazon Alexa, choose "Skill" in the option bar, and then search "Gosund" in the search

bar; select "Gosund" in the search result and then click "Enable".

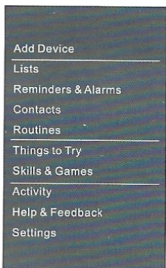

1. Input your account and password that you have registered at "Gosund" APP. When you set the right page, it means your Alexa account is connected with your "Gosund" account.

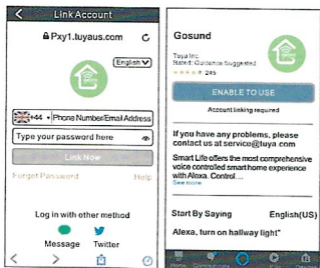

B. Control Smart Plug by Voice
After Alexa is linked to your "Gosund" App, you can now control the socket via Echo.

1. Discovering devices Simply say to Echo: "Echo (or Alexa), discover my device." or choose "add device" to discover the smart plug. Echo will start to find the device

which is added in "Gosund" app. It will take about 20 seconds to show the result. Or you may click "Discover devices" on the Alexa App, and it will successfully show available devices.

Note: "Echo" is one of the wake-up name, the other two names are Alexa and Amazon.



2. Support Skill List

You can control devices by instructions like below:

"Alexa, turn on/off (name of the smart socket)"

"Alexa, turn on lamp."

"Alexa, turn off lamp."

Note: The name of the device must be consistent with the name of the plug on the "Gosund" App. The

name is recommended to use easy pronunciation of English words. (Amazon Echo just supports English temporarily.)

▶ After-sale & Warranty

All Gosund products come with a limited warranty of 12 months from the date of purchase.

And we have a professional customer team to attend to your questions or comments concerning our products. Please do not hesitate to contact us at

service.eu@gosund.com

Or at our Official Facebook:

<https://www.facebook.com/gosund.official/>

We will do our best to help you resolve any problems you might have about our products until you are satisfied.

We appreciate your support and cooperation.



4.02.000.0331 V1.1